

RAXIT®

Made in Denmark

Door Seal and Shielding strip



- Acid Resistant Stainless Steel
- Increased Robustness

Raxit®

For further information visit raxit.net

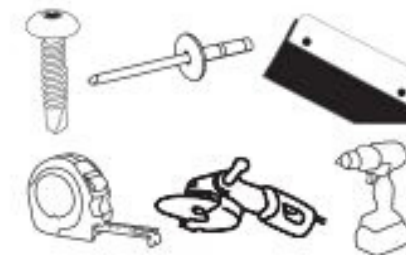

- Self-Drilling Stainless Steel Screw
Type nr: A2 4,8 mm x 32 or
Blind Rivet alu 4,8 x 14 mm
- Raxit® Ready-To-Use seal 1 m
- Measuring tape
- Grinder
- Power Drill

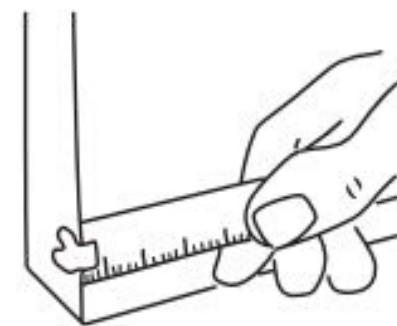

1

Measure the Door



2

Cut the Raxit® Strip

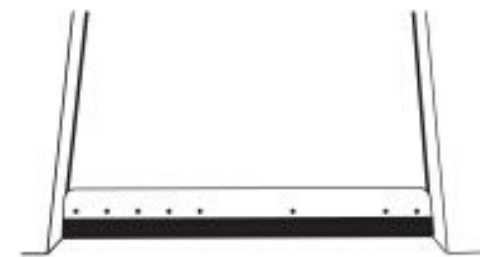

3

Place the Raxit® Strip
on the door - adjust to
surface

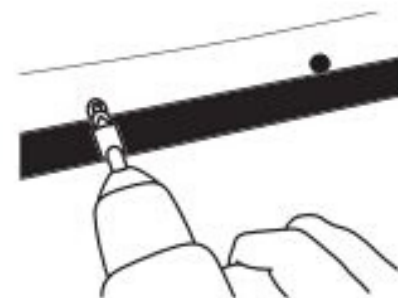

4

Attach with screws
or blind rivets



5

Remove the cable ties
and drill the remaining
holes

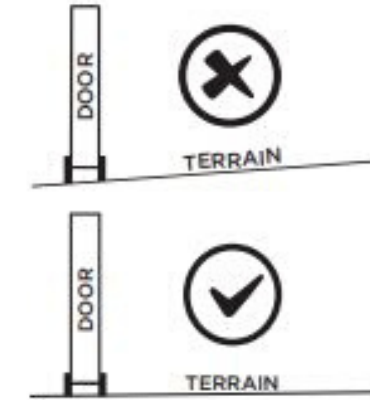

The terrain in front of the
door should preferably fall
away from the door or have
a max increase of 1 cm/m